

**Y (6kV)**

**Main Specifications & Technical Data**

Type	Power (kW)	Current (A)	Speed (r/min)	Eff. (%)	Power Factor (cosΦ)	Max. Torque Rated Torque	Stall Torque Rated Torque	Stall Current Rated Current	Moment of Inertia		Wt. (kg)
									Motor kg·m <sup>2</sup>	Load kg·m <sup>2</sup>	
Y3553-4	220	26.7	1480	93.3	0.85	1.8	0.8	6.5	3.0	161	1720
Y3554-4	250	30.3	1480	93.4	0.85	1.8	0.8	6.5	4.0	161	1760
Y3555-4	280	33.5	1480	93.5	0.86	1.8	0.8	6.5	4.0	161	1800
Y3556-4	315	37.7	1480	93.6	0.86	1.8	0.8	6.5	4.0	161	1860
Y4001-4	355	42.3	1485	93.8	0.86	1.8	0.8	6.5	6.0	161	2280
Y4002-4	400	47.6	1485	94.0	0.86	1.8	0.8	6.5	6.0	161	2350
Y4003-4	450	53.4	1485	94.2	0.86	1.8	0.8	6.5	7.0	161	2430
Y4004-4	500	58.6	1485	94.3	0.87	1.8	0.8	6.5	7.0	161	2520
Y4005-4	560	65.5	1485	94.5	0.87	1.8	0.8	6.5	8.0	161	2610
Y4501-4	630	73.5	1485	94.8	0.87	1.8	0.8	6.5	11	161	3170
Y4502-4	710	82.7	1485	95.0	0.87	1.8	0.8	6.5	12	161	3250
Y4503-4	800	93.0	1485	95.1	0.87	1.8	0.8	6.5	13	161	3370
Y4504-4	900	104.6	1485	95.2	0.87	1.8	0.8	6.5	14	161	3590
Y5001-4	1000	116.1	1490	95.3	0.87	1.8	0.8	6.5	24	161	4150
Y5002-4	1120	128.4	1490	95.4	0.88	1.8	0.8	6.5	26	161	4300
Y5003-4	1250	143.1	1490	95.5	0.88	1.8	0.8	6.5	30	161	4600
Y5004-4	1400	160.1	1490	95.6	0.88	1.8	0.8	6.5	32	161	4770
Y5601-4	1600	180.8	1490	95.7	0.89	1.8	0.8	6.5	57	161	6350
Y5602-4	1800	203.1	1490	95.8	0.89	1.8	0.8	6.5	60	161	6580
Y5603-4	2000	225.5	1490	95.9	0.89	1.8	0.8	6.5	66	161	6750
Y6301-4	2240	252.3	1490	96.0	0.89	1.8	0.8	6.5	102	161	8760
Y6302-4	2500	281.3	1490	96.1	0.89	1.8	0.8	6.5	112	161	9170
Y6303-4	2800	314.7	1490	96.2	0.89	1.8	0.8	6.5	119	161	9390
Y3555-6	220	27.8	990	93.0	0.82	1.8	0.8	6.5	6.0	210	2130
Y3556-6	250	31.4	990	93.3	0.82	1.8	0.8	6.5	7.0	236	2270
Y4002-6	280	34.7	990	93.5	0.83	1.8	0.8	6.5	10	262	2300
Y4003-6	315	39.0	990	93.7	0.83	1.8	0.8	6.5	11	291	2360
Y4004-6	355	43.8	990	93.9	0.83	1.8	0.8	6.5	11	324	2440
Y4005-6	400	49.3	990	94.0	0.83	1.8	0.8	6.5	12	361	2530
Y4501-6	450	54.7	990	94.3	0.84	1.8	0.8	6.5	15	401	3130
Y4502-6	500	59.9	990	94.5	0.85	1.8	0.8	6.5	16	440	3210
Y4503-6	560	66.9	990	94.7	0.85	1.8	0.8	6.5	17	487	3310
Y4504-6	630	75.2	990	94.8	0.85	1.8	0.8	6.5	20	540	3540
Y5001-6	710	84.6	990	95.0	0.85	1.8	0.7	6.5	32	599	4070
Y5002-6	800	95.2	990	95.1	0.85	1.8	0.7	6.5	34	665	4210
Y5003-6	900	107.0	990	95.2	0.85	1.8	0.7	6.5	40	736	4500
Y5004-6	1000	118.8	990	95.3	0.85	1.8	0.7	6.5	47	805	4630

## Y (6kV) cont.

Y5601-6	1120	131.4	990	95.4	0.86	1.8	0.7	6.5	70	886	6100
Y5602-6	1250	146.5	990	95.5	0.86	1.8	0.7	6.5	75	972	6400
Y5603-6	1400	163.9	990	95.6	0.86	1.8	0.7	6.5	82	1068	6530
Y6301-6	1600	187.1	990	95.7	0.86	1.8	0.7	6.5	147	1192	8490
Y6302-6	1800	210.2	990	95.8	0.86	1.8	0.7	6.5	162	1312	8930
Y6303-6	2000	233.3	990	95.9	0.86	1.8	0.7	6.5	173	1428	9140
Y4003-8	220	26.5	740	92.9	0.78	1.8	0.8	5.5	11	424	2430
Y4005-8	250	32.7	740	93.0	0.79	1.8	0.8	5.5	12	477	2500
Y4005-8	280	36.6	740	93.2	0.79	1.8	0.8	5.5	13	529	2590
Y4501-8	315	40.6	740	93.4	0.80	1.8	0.8	5.5	16	588	3200
Y4502-8	355	45.7	740	93.5	0.80	1.8	0.8	5.5	17	656	3280
Y4503-8	400	51.3	740	93.7	0.80	1.8	0.8	5.5	18	731	3400
Y4504-8	450	57.0	740	93.8	0.81	1.8	0.8	5.5	19	813	3500
Y5001-8	500	63.0	740	94.3	0.81	1.8	0.8	5.5	30	894	3930
Y5002-8	560	69.6	740	94.4	0.82	1.8	0.8	5.5	34	989	4170
Y5003-8	630	78.2	740	94.5	0.82	1.8	0.8	5.5	38	1099	4340
Y5004-8	710	88.1	740	94.6	0.82	1.8	0.8	5.5	42	1222	4600
Y5601-8	800	96.8	740	94.7	0.84	1.8	0.7	6.0	87	1357	5910
Y5602-8	900	108.8	740	94.8	0.84	1.8	0.7	6.0	92	1505	6100
Y5603-8	1000	120.7	740	94.9	0.84	1.8	0.7	6.0	102	1650	6390
Y6301-8	1120	135.1	745	95.0	0.84	1.8	0.7	6.0	137	1820	8230
Y6302-8	1250	150.6	745	95.1	0.84	1.8	0.7	6.0	151	2001	8490
Y6303-8	1400	168.5	745	95.2	0.84	1.8	0.7	6.0	160	2204	8820
Y6304-8	1600	192.3	745	95.3	0.84	1.8	0.7	6.0	168	2468	9020
Y4501-10	220	29.9	590	92.1	0.77	1.8	0.8	5.5	19	729	3020
Y4502-10	250	33.4	590	92.3	0.78	1.8	0.8	5.5	20	820	3100
Y4503-10	280	37.3	590	92.5	0.78	1.8	0.8	5.5	22	910	3190
Y4504-10	315	41.4	590	92.6	0.79	1.8	0.8	5.5	24	1014	3290
Y4505-10	355	46.6	590	92.8	0.79	1.8	0.8	5.5	25	1131	3390
Y5001-10	400	51.6	590	93.3	0.80	1.8	0.8	5.5	36	1261	3880
Y5002-10	450	57.9	590	93.4	0.80	1.8	0.8	5.5	38	1404	3980
Y5003-10	500	64.3	590	93.6	0.80	1.8	0.8	5.5	42	1544	4120
Y5004-10	560	71.9	590	93.7	0.80	1.8	0.8	5.5	45	1711	4260
Y5005-10	630	80.8	590	93.8	0.80	1.8	0.8	5.5	52	1902	4580
Y5601-10	710	88.6	595	94.0	0.82	1.8	0.7	6.0	79	2116	5840
Y5602-10	800	99.7	595	94.2	0.82	1.8	0.7	6.0	88	2355	6010
Y5603-10	900	112.0	595	94.3	0.82	1.8	0.7	6.0	93	2615	6170

**Y (6kV) cont.**

Y6301-10	1000	125.6	595	93.4	0.82	1.8	0.7	6.0	140	2870	7830
Y6302-10	1120	138.9	595	94.6	0.82	1.8	0.7	6.0	152	3170	8120
Y6303-10	1250	154.7	595	94.8	0.82	1.8	0.7	6.0	167	3489	8430
Y6304-10	1400	173.1	595	94.9	0.82	1.8	0.7	6.0	175	3850	8630
Y4504-12	220	31.7	495	91.4	0.73	1.8	0.8	5.5	24	1135	3280
Y4505-12	250	35.9	495	91.7	0.73	1.8	0.8	5.5	26	1277	3390
Y5001-12	280	39.3	495	92.7	0.74	1.8	0.8	5.5	40	1418	3900
Y5002-12	315	43.6	495	92.8	0.75	1.8	0.8	5.5	42	1580	3990
Y5003-12	355	49.0	495	93.8	0.75	1.8	0.8	5.5	43	1764	4030
Y5004-12	400	55.0	495	93.3	0.75	1.8	0.8	5.5	47	1967	4180
Y5005-12	450	61.8	495	93.4	0.75	1.8	0.8	5.5	50	2191	4340
Y5601-12	500	65.0	495	93.7	0.79	1.8	0.7	6.0	103	2411	5660
Y5602-12	560	72.7	495	93.8	0.79	1.8	0.7	6.0	114	2673	5850
Y5603-12	630	81.7	495	93.9	0.79	1.8	0.7	6.0	127	2974	6050
Y6301-12	710	92.0	495	94.0	0.79	1.8	0.7	6.0	191	3312	7620
Y6302-12	800	103.4	495	94.2	0.79	1.8	0.7	6.0	208	3688	7910
Y6303-12	900	116.2	495	94.3	0.79	1.8	0.7	6.0	227	4098	8200
Y6304-12	1000	129.0	495	94.4	0.79	1.8	0.7	6.0	239	4520	8410

# YKK (6kV)

## Main Specifications & Technical Data

Type	Power (KW)	Current (A)	Speed (r/min)	Eff. (%)	Power Factor cosΦ	Max. Torque Rated Torque	Stall Torque Rated Torque	Stall Current Rated Current	Moment of Inertia		Wt. (kg)
									Motor kg·m <sup>2</sup>	Load kg·m <sup>2</sup>	
YKK3551-4	185	22.6	1485	92.8	0.85	2.84	1.7	6.5	3	78	1870
YKK3552-4	200	24.4	1485	92.9	0.85	2.62			3	78	1890
YKK3553-4	220	26.8	1485	93.0	0.85	2.52			4	88	1930
YKK3554-4	250	30.4	1485	93.1	0.85	2.46			4	97	2640
YKK4002-4	280	33.6	1485	93.2	0.86	2.72			6	108	2898
YKK4003-4	315	37.8	1485	93.3	0.86	2.71			6	120	2993
YKK4004-4	355	42.5	1485	93.5	0.86	2.64			6	133	3112
YKK40054	400	47.8	1485	93.7	0.86	2.70			7	147	3258
YKK4006-4	450	53.6	1485	93.9	0.86	2.52			7	161	3293
YKK4502-4	500	59.5	1485	94	0.86	2.40			10	178	4286
YKK4503-4	560	66.5	1485	94.2	0.86	2.44			11	197	4447
YKK4504-4	630	74.7	1485	94.4	0.86	2.53			12	218	4684
YKK4505-4	710	84	1485	94.6	0.86	2.50			13	241	4905
YKK5001-4	800	93.3	1490	94.8	0.87	2.70			22	266	4350
YKK5002-4	900	104.9	1490	94.9	0.87	2.65			24	290	4490
YKK5003-4	1000	116.4	1490	95.0	0.87	2.70			26	318	4680
YKK5004-4	1120	120.3	1490	95.1	0.87	2.72			30	347	4980
YKK5601-4	1250	143.6	1490	95.2	0.88	2.39	0.6	51	379	6530	
YKK5602-4	1400	160.6	1490	95.3	0.88	2.35		57	420	6760	
YKK5603-4	1600	183.4	1490	95.4	0.88	2.36		60	460	6690	
YKK6301-4	1800	206.1	1490	95.5	0.88	2.11		96	498	9100	
YKK6302-4	2000	228.8	1490	95.6	0.88	2.22		102	540	9500	
YKK6303-4	2240	255.9	1490	95.7	0.88	2.18		112	584	9910	
YKK4001-6	185	23.5	990	92.4	0.82	2.62	0.7	6.0	8	193	2300
YKK4002-6	200	25.3	990	92.6	0.82	2.60			9	210	2370
YKK4003-6	220	27.8	990	92.8	0.82	2.60			9	236	2410
YKK4004-6	250	31.5	990	93.0	0.82	2.42			10	262	2520
YKK4005-6	280	35.2	990	93.3	0.82	2.40			11	291	2590
YKK4006-6	315	39.5	990	93.5	0.82	2.32			11	324	2670
YKK4502-6	355	43.9	990	93.7	0.83	2.56			14	361	3290
YKK4503-6	400	49.4	990	93.8	0.83	2.58			15	401	3380
YKK4504-6	450	55.4	990	94.1	0.83	2.60			16	440	3510
YKK4505-6	500	61.5	990	94.3	0.83	2.71			17	487	3600
YKK5001-6	560	68	990	94.4	0.83	2.41			27	540	6000
YKK5002-6	630	76.4	990	94.5	0.84	2.59			32	599	6170
YKK5003-6	710	85.8	990	94.8	0.84	2.53			34	665	6395
YKK5004-6	800	96.6	990	94.9	0.84	2.60	40	736	6795		

## YKK (6kV) cont.

YKK5601-6	900	107.2	995	95.0	0.85	1.8	0.7	6.5	64	805	6380
YKK5602-6	1000	119	995	95.1	0.85	1.8	0.7	6.5	70	886	6610
YKK5603-6	1120	133.2	995	95.2	0.85	1.8	0.7	6.5	75	927	6910
YKK6301-6	1250	146.8	995	95.3	0.86	1.8	0.7	6.5	139	1068	9010
YKK6302-6	1400	164.2	995	95.4	0.86	1.8	0.7	6.5	147	1192	9230
YKK6303-6	1600	187.5	995	95.5	0.86	1.8	0.7	6.5	162	1312	9880
YKK4004-8	185	24.7	745	92.5	0.78	1.8	0.8	5.5	11	406	2620
YKK4005-8	200	26.6	745	92.7	0.78	1.8	0.8	5.5	12	450	2690
YKK4006-8	220	29.2	745	92.9	0.78	1.8	0.8	5.5	13	502	2820
YKK4502-8	250	32.7	745	93	0.79	1.8	0.8	5.5	16	558	3820
YKK4503-8	280	36.6	745	93.2	0.79	1.8	0.8	5.5	17	622	3940
YKK4504-8	315	41.1	745	93.4	0.79	1.8	0.8	5.5	18	693	4105
YKK4505-8	355	46.2	745	93.5	0.79	1.8	0.8	5.5	19	772	4310
YKK5001-8	400	51.3	745	93.7	0.80	1.8	0.8	5.5	30	853	4270
YKK5002-8	450	57.7	745	93.8	0.80	1.8	0.8	5.5	34	941	4560
YKK5003-8	500	63.8	745	94.2	0.80	1.8	0.8	5.5	38	1044	4710
YKK5004-8	560	71.4	745	94.4	0.80	1.8	0.8	5.5	42	1160	4980
YKK5601-8	630	78.2	745	94.5	0.82	1.8	0.7	6.0	79	1221	6240
YKK5602-8	710	88.1	745	94.6	0.82	1.8	0.7	6.0	87	1357	6420
YKK5603-8	800	99.1	745	94.7	0.82	1.8	0.7	6.0	92	1505	6610
YKK6301-8	900	108.7	745	94.8	0.84	1.8	0.7	6.0	129	1650	8700
YKK6302-8	1000	120.7	745	94.9	0.84	1.8	0.7	6.0	137	1820	8970
YKK6303-8	1120	135.1	745	95.0	0.84	1.8	0.7	6.0	151	2001	9230
YKK6304-8	1250	150.5	745	95.1	0.84	1.8	0.7	6.0	160	2204	9560
YKK4501-10	185	25.9	595	91.7	0.75	1.8	0.8	5.5	19	698	3270
YKK4502-10	200	27.9	595	91.9	0.75	1.8	0.8	5.5	20	775	3360
YKK4503-10	220	30.6	595	92.1	0.75	1.8	0.8	5.5	22	865	3450
YKK4504-10	250	34.8	595	92.3	0.75	1.8	0.8	5.5	24	962	3590
YKK4505-10	280	38.8	595	92.5	0.75	1.8	0.8	5.5	26	1072	3700
YKK5001-10	315	43	595	92.8	0.76	1.8	0.8	5.5	36	1196	4220
YKK5002-10	355	48.3	595	93	0.76	1.8	0.8	5.5	38	1332	4320
YKK5003-10	400	54.3	595	93.3	0.76	1.8	0.8	5.5	42	1474	4500
YKK5004-10	450	61	595	93.4	0.76	1.8	0.8	5.5	45	1627	4640
YKK5601-10	500	65.9	595	93.6	0.78	1.8	0.7	6.0	67	1710	5990
YKK5602-10	560	73.7	595	93.7	0.78	1.8	0.7	6.0	74	1902	6170
YKK5603-10	630	82.9	595	93.8	0.78	1.8	0.7	6.0	79	2116	6350
YKK5604-10	710	93.2	595	94.0	0.78	1.8	0.7	6.0	88	2355	6520

## YKK (6kV) cont.

YKK6301-10	800	102.1	595	94.2	0.815	1.8	0.7	6.0	132	2615	8330
YKK6302-10	900	114.8	595	94.3	0.815	1.8	0.7	6.0	140	2870	8570
YKK6303-10	1000	127.4	595	94.4	0.818	1.8	0.7	6.0	152	3170	8860
YKK6304-10	1120	142.4	595	94.6	0.820	1.8	0.7	6.0	167	3489	9170
YKK4504-12	185	27.7	495	91.8	0.708	1.8	0.8	5.5	24	1087	3590
YKK4505-12	200	29.9	495	92.0	0.712	1.8	0.8	5.5	26	1206	3680
YKK5001-12	220	31.9	496	92.2	0.733	1.8	0.8	5.5	40	1347	4230
YKK5002-12	250	36.1	495	92.5	0.739	1.8	0.8	5.5	42	1499	4330
YKK5003-12	280	40.4	496	92.7	0.730	1.8	0.8	5.5	43	1672	4410
YKK5004-12	315	45.4	495	92.8	0.738	1.8	0.8	5.5	47	1865	4550
YKK5601-12	355	49.6	496	93.0	0.760	1.8	0.7	6.0	87	4967	5750
YKK5602-12	400	55.7	496	93.3	0.760	1.8	0.7	6.0	96	2190	5940
YKK5603-12	450	62.7	496	93.4	0.764	1.8	0.7	6.0	103	2411	6170
YKK5604-12	500	69.4	496	93.7	0.764	1.8	0.7	6.0	114	2673	6360
YKK6301-12	560	75.6	496	93.8	0.783	1.8	0.7	6.0	179	2974	
YKK6302-12	630	84.9	496	93.9	0.788	1.8	0.7	6.0	191	3312	
YKK6303-12	710	95.6	496	94	0.790	1.8	0.7	6.0	208	3688	
YKK6304-12	800	107.5	496	94.2	0.790	1.8	0.7	6.0	272	409	

## Y (10kV)

### Main Specifications & Technical Data

Y4501-4	220	16.3	1480	92.5	0.84	1.8	0.7	7.0	9.0	78.0	2550
Y4502-4	250	18.5	1480	92.7	0.84	1.8	0.7	7.0	9.5	87.0	2645
Y4503-4	280	20.5	1480	92.9	0.85	1.8	0.7	7.0	10.2	97.0	2710
Y4504-4	315	23.0	1480	93.1	0.85	1.8	0.7	7.0	10.8	107.0	2790
Y4505-4	355	25.5	1480	93.3	0.86	1.8	0.7	7.0	12.0	119.0	2850
Y4506-4	400	28.7	1480	93.5	0.86	1.8	0.7	7.0	12.5	132.0	2915
Y4507-4	450	32.2	1480	93.9	0.86	1.8	0.7	7.0	12.9	147.0	3180
Y4508-4	500	35.7	1480	94.0	0.86	1.8	0.7	7.0	13.4	161.0	3315
Y4509-4	560	39.9	1480	94.2	0.86	1.8	0.7	7.0	13.8	178.0	3380
Y45010-4	630	44.8	1480	94.4	0.86	1.8	0.7	7.0	14.7	196.0	3461
Y5001-4	710	49.6	1485	95.0	0.87	1.8	0.7	7.0	22.0	217.0	4550
Y5002-4	800	55.8	1485	95.1	0.87	1.8	0.7	7.0	23.0	240.0	4600
Y5003-4	900	62.0	1485	95.2	0.88	1.8	0.7	7.0	25.0	265.0	4750
Y5004-4	1000	68.8	1485	95.3	0.88	1.8	0.7	7.0	27.0	289.0	4850
Y5005-4	1120	77.0	1485	95.4	0.88	1.8	0.7	7.0	29.0	317.0	5150
Y5601-4	1250	84.9	1485	95.5	0.89	1.8	0.7	7.0	40.0	347.0	6225
Y5602-4	1400	94.9	1485	95.7	0.89	1.8	0.7	7.0	43.0	379.0	6720
Y5603-4	1600	108.3	1485	95.8	0.89	1.8	0.7	7.0	46.0	421.0	7150
Y6301-4	1800	121.8	1485	95.9	0.89	1.8	0.6	7.0	86.0	460	9250
Y6302-4	2000	135.1	1485	96.0	0.89	1.8	0.6	7.0	91.0	498	9700
Y6303-4	2240	151.2	1485	96.1	0.89	1.8	0.6	7.0	96.0	540	10600
Y4504-6	220	17.0	990	92.2	0.81	1.8	0.7	6.0	13.2	210	2800
Y4505-6	250	19.3	990	92.4	0.81	1.8	0.7	6.0	13.4	236	2850
Y4506-6	280	21.3	990	92.6	0.82	1.8	0.7	6.0	13.6	261	2950
Y4507-6	315	23.9	990	92.8	0.82	1.8	0.7	6.0	14.7	291	3070
Y4508-6	355	26.6	990	93.1	0.83	1.8	0.7	6.0	15.7	324	3175
Y4509-6	400	30	990	93.3	0.83	1.8	0.7	6.0	17.7	361	3295
Y45010-6	450	33.5	990	93.5	0.83	1.8	0.7	6.0	18.2	400	3377
Y5001-6	500	37.0	990	93.9	0.83	1.8	0.7	6.0	23.0	440	4550
Y5002-6	560	40.9	990	94.1	0.84	1.8	0.7	6.0	25.0	486	4600
Y5003-6	630	45.9	990	94.4	0.84	1.8	0.7	6.0	27.0	539	4790
Y5004-6	710	51.6	990	94.6	0.84	1.8	0.7	6.0	29.0	599	4930
Y5005-6	800	58.1	990	94.7	0.84	1.8	0.7	6.0	31.0	664	5050
Y5601-6	900	64.4	990	94.9	0.85	1.8	0.7	6.0	49.0	735	6085
Y5602-6	1000	71.4	990	95.1	0.85	1.8	0.7	6.0	53.0	805	6415
Y5603-6	1120	79.8	990	95.3	0.85	1.8	0.7	6.0	56.0	886	6670
Y5604-6	1250	88.0	990	95.4	0.86	1.8	0.7	6.0	60.0	972	6920

## Y (10kV) cont.

Y6301-6	1400	98.2	990	95.7	0.86	1.8	0.6	6.0	114.0	1068	9300
Y6302-6	1600	112.1	990	95.8	0.86	1.8	0.6	6.0	121.0	1192	9700
Y6303-6	1800	126.0	990	95.9	0.86	1.8	0.6	6.0	128.0	1312	10500
Y4508-8	220	17.9	740	92.2	0.77	1.8	0.7	6.0	16.0	423	2927
Y4509-8	250	20.3	740	92.4	0.77	1.8	0.7	6.0	17.0	476	3241
Y45010-8	280	22.7	740	92.6	0.77	1.8	0.7	6.0	18.0	528	3383
Y5001-8	315	25.5	740	92.8	0.77	1.8	0.7	6.0	22.0	588	4500
Y5002-8	355	28.6	740	93.1	0.77	1.8	0.7	6.0	24.0	656	4580
Y5003-8	400	31.7	740	93.2	0.78	1.8	0.7	6.0	26.0	730	4700
Y5004-8	450	35.7	740	93.4	0.78	1.8	0.7	6.0	28.0	812	4850
Y5005-8	500	39.0	740	93.8	0.79	1.8	0.7	6.0	30.0	893	5960
Y5006-8	560	43.6	740	93.9	0.79	1.8	0.7	6.0	32.0	989	6100
Y5601-8	630	47.0	740	94.4	0.82	1.8	0.7	6.0	56.0	1096	6325
Y5602-8	710	52.8	740	94.6	0.82	1.8	0.7	6.0	60.0	1221	6470
Y5603-8	800	59.5	740	94.7	0.82	1.8	0.7	6.0	63.0	1357	6620
Y5604-8	900	66.8	740	94.8	0.82	1.8	0.7	6.0	67.0	1505	6760
Y6301-8	1000	73.2	740	95.0	0.83	1.8	0.7	6.0	141.0	165.0	9620
Y6302-8	1120	81.8	740	95.2	0.83	1.8	0.7	6.0	149.0	1820	10200
Y6303-8	1250	91.2	740	95.3	0.83	1.8	0.7	6.0	157.0	2001	10570
Y5001-10	220	18.7	590	91.9	0.74	1.8	0.7	5.5	27.0	740	4500
Y5002-10	250	21.2	590	92.2	0.74	1.8	0.7	5.5	27.5	820	4500
Y5003-10	280	23.7	590	92.4	0.74	1.8	0.7	5.5	28.0	910	4720
Y5004-10	315	26.6	590	92.6	0.74	1.8	0.7	5.5	30.0	1014	4840
Y5005-10	355	29.5	590	92.8	0.75	1.8	0.7	5.5	31.3	1131	4970
Y5006-10	400	33.2	590	93.0	0.75	1.8	0.7	5.5	32.0	1210	5090
Y5601-10	450	36.2	595	93.2	0.77	1.8	0.7	6.0	75.0	1403	6160
Y5602-10	500	40.1	595	93.4	0.77	1.8	0.7	6.0	80.0	1544	6360
Y5603-10	560	44.3	595	93.5	0.78	1.8	0.7	6.0	84.0	1710	6570
Y5604-10	630	49.8	595	93.7	0.78	1.8	0.7	6.0	89.0	1902	6780
Y5605-10	710	56.0	595	93.9	0.78	1.8	0.7	6.0	94.0	2117	6990
Y6301-10	800	61.2	595	94.3	0.80	1.8	0.7	6.0	144.0	2355	9620
Y6302-10	900	68.7	595	94.5	0.80	1.8	0.7	6.0	153.0	2614	10200
Y6303-10	1000	76.3	595	94.6	0.80	1.8	0.7	6.0	161.0	2870	10570
Y6304-10	1120	85.4	595	94.7	0.80	1.8	0.7	6.0	169.0	3170	10930
Y5004-12	220	19.1	490	91.2	0.73	1.8	0.7	6.0	43.0	1135	4770
Y5005-12	250	21.6	490	91.6	0.73	1.8	0.7	6.0	47.0	1210	4880
Y5006-12	280	24.1	490	92.0	0.73	1.8	0.7	6.0	50.0	1418	5030

**Y (10kV) cont.**

Y5601-12	315	27.0	494	92.3	0.73	1.8	0.7	6.0	73.0	1580	6060
Y5602-12	355	30.3	495	92.5	0.73	1.8	0.7	6.0	77.0	1763	6255
Y5603-12	400	34.1	495	92.7	0.73	1.8	0.7	6.0	82.0	1967	6450
Y5604-12	450	38.3	495	92.9	0.73	1.8	0.7	6.0	87.0	2190	6640
Y5605-12	500	42.4	495	93.2	0.73	1.8	0.7	6.0	92.0	2411	6830
Y6301-12	560	46.7	495	93.5	0.74	1.8	0.7	6.0	119.0	2672	9600
Y6302-12	630	52.5	495	93.7	0.74	1.8	0.7	6.0	136.0	2974	10050
Y6303-12	710	59.0	495	93.9	0.74	1.8	0.7	6.0	152.0	3313	10450
Y6304-12	800	66.2	495	94.3	0.74	1.8	0.7	6.0	160.0	3688	10820

## YKK (10kV)

### Main Specifications & Technical Data

YKK4501-4	220	16.6	1480	92.4	0.83	1.8	0.7	7.0	11.4	78.0	3700
YKK4502-4	250	18.8	1480	92.6	0.83	1.8	0.7	7.0	12.6	87.0	3760
YKK4503-4	280	21	1480	92.8	0.83	1.8	0.7	7.0	13.1	97.0	3860
YKK4504-4	315	23.6	1480	93.0	0.83	1.8	0.7	7.0	13.5	107.0	3890
YKK4505-4	355	25.5	1480	93.3	0.86	1.8	0.7	7.0	14.0	119.0	4200
YKK4506-4	400	28.7	1480	93.5	0.86	1.8	0.7	7.0	14.4	132.0	4300
YKK4507-4	450	32.2	1480	93.9	0.86	1.8	0.7	7.0	15.3	147.0	4490
YKK5001-4	500	35.7	1485	94.0	0.86	1.8	0.7	7.0	25.0	165.0	5640
YKK5002-4	560	40.0	1485	94.2	0.86	1.8	0.7	7.0	26.0	182.0	5660
YKK5003-4	630	44.8	1485	94.4	0.86	1.8	0.7	7.0	28.0	201.0	5850
YKK5004-4	710	50.4	1485	94.6	0.86	1.8	0.7	7.0	30.0	220.0	6030
YKK5005-4	800	56.0	1485	94.8	0.87	1.8	0.7	7.0	32.0	242.0	6060
YKK5601-4	900	63.0	1485	94.9	0.87	1.8	0.7	7.0	44.0	270.0	7800
YKK5602-4	1000	70.0	1485	95.0	0.87	1.8	0.7	7.0	47.0	292.0	8050
YKK5603-4	1120	78.0	1485	95.1	0.87	1.8	0.7	7.0	50.0	320.0	8300
YKK6301-4	1250	86.1	1485	95.2	0.88	1.8	0.6	7.0	90.0	350.0	9900
YKK6302-4	1400	96.4	1485	95.3	0.88	1.8	0.6	7.0	95.0	382.0	10300
YKK6303-4	1600	110.0	1485	95.4	0.88	1.8	0.6	7.0	101.0	423.0	10400
YKK4504-6	220	17.3	985	92.0	0.80	1.8	0.7	7.0	15.5	210.0	4090
YKK4505-6	250	19.6	985	92.2	0.80	1.8	0.7	7.0	16.3	235.0	4210
YKK4506-6	280	21.9	985	92.5	0.80	1.8	0.7	7.0	17.4	260.0	4420
YKK4507-6	315	23.9	985	92.8	0.80	1.8	0.7	7.0	18.4	290	4560
YKK5001-6	355	26.6	985	93.1	0.83	1.8	0.7	6.0	27.0	326	5360
YKK5002-6	400	29.8	985	93.3	0.83	1.8	0.7	6.0	29.0	362	5440
YKK5003-6	450	33.5	985	93.5	0.83	1.8	0.7	6.0	31.0	400	5700
YKK5004-6	500	37.1	985	93.9	0.83	1.8	0.7	6.0	33.0	485	5880
YKK5005-6	560	40.9	985	94.1	0.84	1.8	0.7	6.0	35.0	485	6110
YKK5601-6	630	45.9	990	94.4	0.84	1.8	0.7	6.0	50.0	540	7500
YKK5602-6	710	51.6	990	94.6	0.84	1.8	0.7	6.0	60.0	599	7850
YKK5603-6	800	58.1	990	94.7	0.84	1.8	0.7	6.0	63.0	665	8100
YKK5604-6	900	64.4	990	94.9	0.84	1.8	0.7	6.0	67.0	730	8300
YKK6301-6	1000	71.4	990	95.1	0.85	1.8	0.7	6.0	121.0	805	10750
YKK6302-6	1120	79.9	990	95.2	0.85	1.8	0.7	6.0	128.0	886	11150
YKK6303-6	1250	88.1	990	95.3	0.85	1.8	0.7	6.0	135.0	970	11500
YKK5001-8	220	18.2	740	92.0	0.76	1.8	0.7	6.0	28.0	423	5280
YKK5002-8	250	20.6	740	92.2	0.76	1.8	0.7	6.0	30.0	476	5430
YKK5003-8	280	23.0	740	92.5	0.76	1.8	0.7	6.0	32.0	530	5660

## YKK (10kV) cont.

YKK5004-8	315	25.5	740	92.8	0.77	1.8	0.7	6.0	34.0	588	5700
YKK5005-8	355	28.6	740	93.1	0.77	1.8	0.7	6.0	36.0	656	5760
YKK5006-8	400	31.8	740	93.2	0.78	1.8	0.7	6.0	38.0	730	5820
YKK5601-8	450	35.7	740	93.4	0.78	1.8	0.7	6.0	63.0	810	7850
YKK5602-8	500	39.0	740	93.8	0.79	1.8	0.7	6.0	67.0	890	8100
YKK5603-8	560	43.6	740	93.9	0.79	1.8	0.7	6.0	70.0	988	8300
YKK5604-8	630	47.0	740	94.4	0.79	1.8	0.7	6.0	74.0	1098	8500
YKK6301-8	710	52.8	740	94.6	0.82	1.8	0.7	6.0	145.0	1221	10400
YKK6302-8	800	59.5	740	94.7	0.82	1.8	0.7	6.0	151.0	1357	10800
YKK6303-8	900	66.8	740	94.8	0.82	1.8	0.7	6.0	166.0	1505	11200
YKK5003-10	220	19.2	590	91.9	0.72	1.8	0.7	5.5	38.0	698	5760
YKK5004-10	250	21.8	590	92.1	0.72	1.8	0.7	5.5	39.3	775	5930
YKK5005-10	280	23.7	590	92.4	0.74	1.8	0.7	5.5	40.0	865	6120
YKK5601-10	315	26.5	590	92.6	0.74	1.8	0.7	6.0	78.0	1014	7350
YKK5602-10	355	29.4	590	92.8	0.75	1.8	0.7	6.0	83.0	1131	7500
YKK5603-10	400	33.1	590	93.0	0.75	1.8	0.7	6.0	87.0	1261	7850
YKK5604-10	450	36.7	590	93.2	0.76	1.8	0.7	6.0	92.0	1403	8100
YKK5605-10	500	40.1	590	93.4	0.77	1.8	0.7	6.0	97.0	1544	8300
YKK6301-10	560	44.3	590	93.5	0.78	1.8	0.7	6.0	153.0	1710	10600
YKK6302-10	630	49.8	590	93.7	0.78	1.8	0.7	6.0	162.0	1902	11000
YKK6303-10	710	56.0	590	93.9	0.78	1.8	0.7	6.0	169.0	2116	11400
YKK6304-10	800	61.2	590	94.3	0.78	1.8	0.7	6.0	178.0	2355	11800
YKK5601-12	220	19.2	495	91.8	0.72	1.8	0.7	6.0	88.0	1135	7350
YKK5602-12	250	21.8	495	92.0	0.72	1.8	0.7	6.0	97.0	1210	7500
YKK5603-12	280	24.4	495	92.1	0.72	1.8	0.7	6.0	100	1418	7850
YKK5604-12	315	27.4	495	92.3	0.72	1.8	0.7	6.0	108	1580	8100
YKK5605-12	355	30.4	495	92.5	0.73	1.8	0.7	6.0	115	1763	8300
YKK6301-12	400	34.1	495	92.7	0.73	1.8	0.7	6.0	139	1967	10600
YKK6302-12	450	38.3	495	92.9	0.73	1.8	0.7	6.0	156	2190	11000
YKK6303-12	500	42.4	495	93.2	0.73	1.8	0.7	6.0	172	2411	11400
YKK6304-12	560	46.7	495	93.5	0.74	1.8	0.7	6.0	180	2672	11800

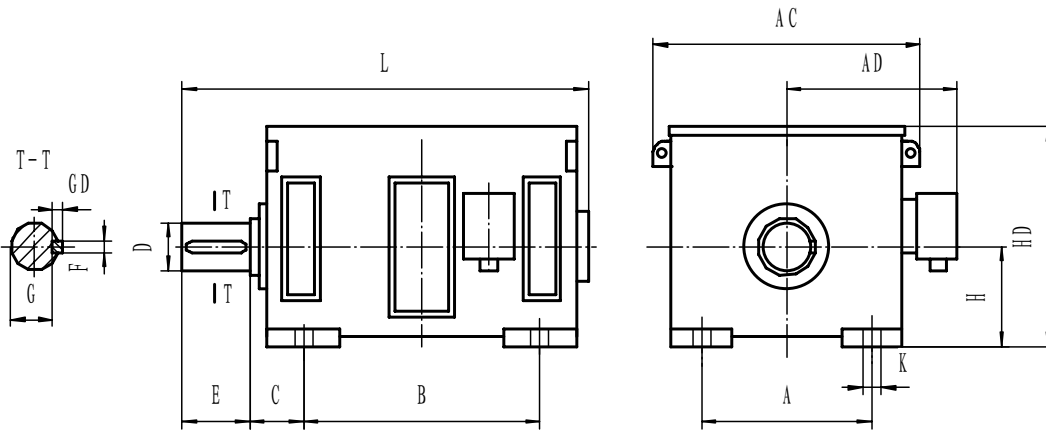

### Y (6 kV)

### Mounting Type IMB3

Frame No.	No. of Poles	Mounting Size (mm)									Overall Dimensions (mm)			
		A	B	C	D	E	FxGD	G	H	K	AC	AD	HD	L
Y355	4-6	630	900	315	100	210	28x16	90	355	28	1100	800	1170	1890
Y400	4-8	710	1000	335	110			100	400					
Y450	4	800	1120	355	120	250	32x18	109	450	42	1300	900	1475	2180
	6-12				130			119						
Y500	4	900	1250	475	140	300	36x20	128	560	48	1420	965	1655	2550
	6-12				150			138						
Y560	4	1000	1400	500	160	300	40x22	147	630	48	1600	1100	1850	2900
	6-12				170			157						
Y630	4	1120	1600	530	180	300	45x25	165	630	48	1800	1200	2050	3100
	6-12				180			165						

### Y (10 kV)

### Mounting Type IMB3

Frame No.	No. of Poles	Mounting Size (mm)									Overall Dimensions (mm)			
		A	B	C	D	E	FxGD	G	H	K	AC	AD	HD	L
Y450	4	800	1120	355	110	210	28x16	100	450	35	1300	1100	1550	2180
	6-12				120									
Y500	4	900	1250	475	130	250	32x18	119	42	1420	1150	1700	2550	
	6-12				150			138						560
Y560	4	1000	1400	500	160	300	36x20	147	630	48	1600	1250	1850	2900
	6-12				170			157						
Y630	4	1120	1600	530	180	300	40x22	165	630	48	1800	1300	2050	3100
	6-12				180			165						

YKK

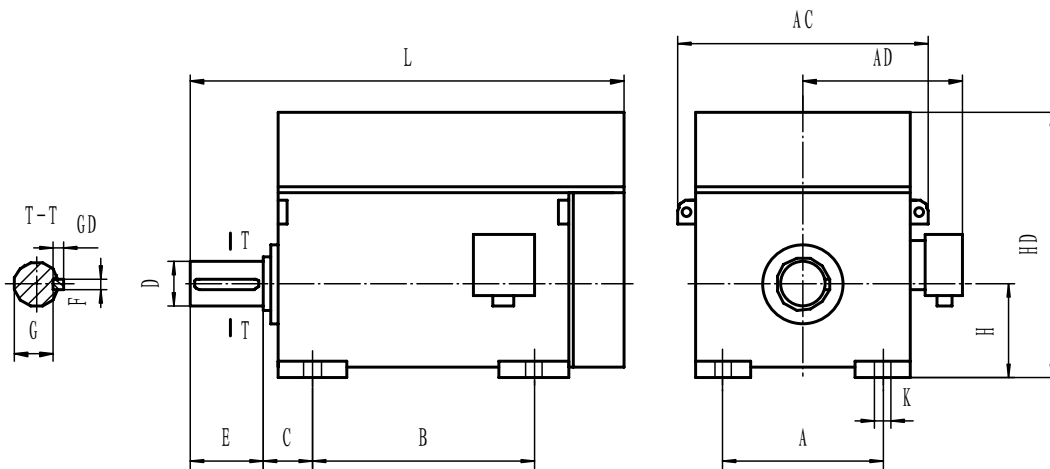

**YKK (6kV) Mounting Type IMB3**

Frame No.	No. of Poles	Mounting Size (mm)									Overall Dimensions (mm)				
		A	B	C	D	E	FxGD	G	H	K	AC	AD	HD	L	
YKK355	4-12	630	900	315	100	210	28x16	90	355	28	35	1120	1000	1500	2200
YKK400	4-12	710	1000	335	110			100	400	1260		1050	1700	2400	
YKK450	4	800	1120	335	120	250	32x18	109	450		42				1420
	6-12				130			119							
YKK500	4	900	1250	475	150	300	36x20	128	500	48	1600	1150	2200	2900	
	6-12				160			138	560						
YKK560	4	1000	1400	500	170	300	40x22	147	630	48	1800	1250	2400	3200	
	6-12				180			157							
YKK630	4	1120	1600	530	170	300	45x25	165	630	48	2000	1300	2700	3500	
	6-12				180										

**YKK (10 kV) Mounting Type IMB3**

Frame No.	No. of Poles	Mounting Size (mm)									Overall Dimensions (mm)			
		A	B	C	D	E	FxGD	G	H	K	AC	AD	HD	L
Y450	4	800	1120	355	110	210	28x16	100	450	35	1420	1100	1900	2600
	6-12													
Y500	4	900	1250	475	120	250	32x18	109	500	42	1600	1150	2200	2900
	6-12				130			119						
Y560	4	1000	1400	500	150	300	36x20	138	560	48	1800	1250	2400	3200
	6-12				160			147						
Y630	4	1120	1600	530	170	300	40x22	157	630	48	2000	1300	2700	3500
	6-12				180									